

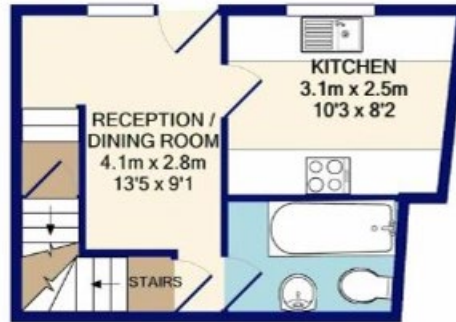

BASEMENT LEVEL
APPROX. FLOOR
AREA 14.1 SQ.M.
(152 SQ.FT.)



GROUND FLOOR
APPROX. FLOOR
AREA 22.6 SQ.M.
(243 SQ.FT.)



1ST FLOOR
APPROX. FLOOR
AREA 22.6 SQ.M.
(243 SQ.FT.)

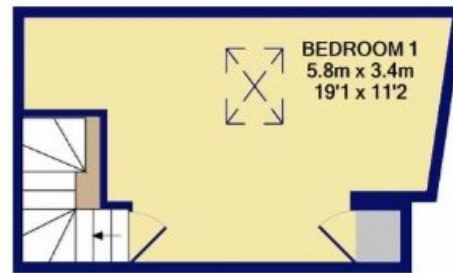

2ND FLOOR
APPROX. FLOOR
AREA 18.7 SQ.M.
(201 SQ.FT.)

TOTAL APPROX. FLOOR AREA 78.0 SQ.M. (839 SQ.FT.)