

Materials prohibited from use, except where used in accordance with 'Good Practice in the Selection of Construction Materials (March 2011)' or unless required by the Contract:

- a) all alumina cement in the structural elements;
- b) water-soluble in cement for reinforcement;
- c) calcium chloride admixtures for use in reinforced concrete;
- d) asbestos or asbestos-containing products, as defined in the Contract of Asbestos and its Addendum, as amended 2017 or any other statutory modification or re-enactment thereof;
- e) any naturally occurring or man-made mineral fibres (for example, rock-wool or glass-wool) in any form, including in the form of dust, fumes or fibres, or, less, unless they are appropriately sealed to prevent migration of fibres;
- f) aggregates for use in reinforced concrete which do not comply with BS EN 12620:2002, BS EN 12620:2002+A1:2007 or BS EN 12620:2002+A2:2007. Products of aggregates used in mortar;
- g) any of the following:
 - 1) BS ISO 13055 Parts 1 & 2: 2007 of Technical Approval 309000;
 - 2) BS EN 12620:2002+A1:2007+A2:2007+A3:2007+A4:2007+A5:2007+A6:2007+A7:2007+A8:2007+A9:2007+A10:2007+A11:2007+A12:2007+A13:2007+A14:2007+A15:2007+A16:2007+A17:2007+A18:2007+A19:2007+A20:2007+A21:2007+A22:2007+A23:2007+A24:2007+A25:2007+A26:2007+A27:2007+A28:2007+A29:2007+A30:2007+A31:2007+A32:2007+A33:2007+A34:2007+A35:2007+A36:2007+A37:2007+A38:2007+A39:2007+A40:2007+A41:2007+A42:2007+A43:2007+A44:2007+A45:2007+A46:2007+A47:2007+A48:2007+A49:2007+A50:2007+A51:2007+A52:2007+A53:2007+A54:2007+A55:2007+A56:2007+A57:2007+A58:2007+A59:2007+A60:2007+A61:2007+A62:2007+A63:2007+A64:2007+A65:2007+A66:2007+A67:2007+A68:2007+A69:2007+A70:2007+A71:2007+A72:2007+A73:2007+A74:2007+A75:2007+A76:2007+A77:2007+A78:2007+A79:2007+A80:2007+A81:2007+A82:2007+A83:2007+A84:2007+A85:2007+A86:2007+A87:2007+A88:2007+A89:2007+A90:2007+A91:2007+A92:2007+A93:2007+A94:2007+A95:2007+A96:2007+A97:2007+A98:2007+A99:2007+A100:2007+A101:2007+A102:2007+A103:2007+A104:2007+A105:2007+A106:2007+A107:2007+A108:2007+A109:2007+A110:2007+A111:2007+A112:2007+A113:2007+A114:2007+A115:2007+A116:2007+A117:2007+A118:2007+A119:2007+A120:2007+A121:2007+A122:2007+A123:2007+A124:2007+A125:2007+A126:2007+A127:2007+A128:2007+A129:2007+A130:2007+A131:2007+A132:2007+A133:2007+A134:2007+A135:2007+A136:2007+A137:2007+A138:2007+A139:2007+A140:2007+A141:2007+A142:2007+A143:2007+A144:2007+A145:2007+A146:2007+A147:2007+A148:2007+A149:2007+A150:2007+A151:2007+A152:2007+A153:2007+A154:2007+A155:2007+A156:2007+A157:2007+A158:2007+A159:2007+A160:2007+A161:2007+A162:2007+A163:2007+A164:2007+A165:2007+A166:2007+A167:2007+A168:2007+A169:2007+A170:2007+A171:2007+A172:2007+A173:2007+A174:2007+A175:2007+A176:2007+A177:2007+A178:2007+A179:2007+A180:2007+A181:2007+A182:2007+A183:2007+A184:2007+A185:2007+A186:2007+A187:2007+A188:2007+A189:2007+A190:2007+A191:2007+A192:2007+A193:2007+A194:2007+A195:2007+A196:2007+A197:2007+A198:2007+A199:2007+A200:2007+A201:2007+A202:2007+A203:2007+A204:2007+A205:2007+A206:2007+A207:2007+A208:2007+A209:2007+A210:2007+A211:2007+A212:2007+A213:2007+A214:2007+A215:2007+A216:2007+A217:2007+A218:2007+A219:2007+A220:2007+A221:2007+A222:2007+A223:2007+A224:2007+A225:2007+A226:2007+A227:2007+A228:2007+A229:2007+A230:2007+A231:2007+A232:2007+A233:2007+A234:2007+A235:2007+A236:2007+A237:2007+A238:2007+A239:2007+A240:2007+A241:2007+A242:2007+A243:2007+A244:2007+A245:2007+A246:2007+A247:2007+A248:2007+A249:2007+A250:2007+A251:2007+A252:2007+A253:2007+A254:2007+A255:2007+A256:2007+A257:2007+A258:2007+A259:2007+A260:2007+A261:2007+A262:2007+A263:2007+A264:2007+A265:2007+A266:2007+A267:2007+A268:2007+A269:2007+A270:2007+A271:2007+A272:2007+A273:2007+A274:2007+A275:2007+A276:2007+A277:2007+A278:2007+A279:2007+A280:2007+A281:2007+A282:2007+A283:2007+A284:2007+A285:2007+A286:2007+A287:2007+A288:2007+A289:2007+A290:2007+A291:2007+A292:2007+A293:2007+A294:2007+A295:2007+A296:2007+A297:2007+A298:2007+A299:2007+A300:2007+A301:2007+A302:2007+A303:2007+A304:2007+A305:2007+A306:2007+A307:2007+A308:2007+A309:2007+A310:2007+A311:2007+A312:2007+A313:2007+A314:2007+A315:2007+A316:2007+A317:2007+A318:2007+A319:2007+A320:2007+A321:2007+A322:2007+A323:2007+A324:2007+A325:2007+A326:2007+A327:2007+A328:2007+A329:2007+A330:2007+A331:2007+A332:2007+A333:2007+A334:2007+A335:2007+A336:2007+A337:2007+A338:2007+A339:2007+A340:2007+A341:2007+A342:2007+A343:2007+A344:2007+A345:2007+A346:2007+A347:2007+A348:2007+A349:2007+A350:2007+A351:2007+A352:2007+A353:2007+A354:2007+A355:2007+A356:2007+A357:2007+A358:2007+A359:2007+A360:2007+A361:2007+A362:2007+A363:2007+A364:2007+A365:2007+A366:2007+A367:2007+A368:2007+A369:2007+A370:2007+A371:2007+A372:2007+A373:2007+A374:2007+A375:2007+A376:2007+A377:2007+A378:2007+A379:2007+A380:2007+A381:2007+A382:2007+A383:2007+A384:2007+A385:2007+A386:2007+A387:2007+A388:2007+A389:2007+A390:2007+A391:2007+A392:2007+A393:2007+A394:2007+A395:2007+A396:2007+A397:2007+A398:2007+A399:2007+A400:2007+A401:2007+A402:2007+A403:2007+A404:2007+A405:2007+A406:2007+A407:2007+A408:2007+A409:2007+A410:2007+A411:2007+A412:2007+A413:2007+A414:2007+A415:2007+A416:2007+A417:2007+A418:2007+A419:2007+A420:2007+A421:2007+A422:2007+A423:2007+A424:2007+A425:2007+A426:2007+A427:2007+A428:2007+A429:2007+A430:2007+A431:2007+A432:2

BOOK

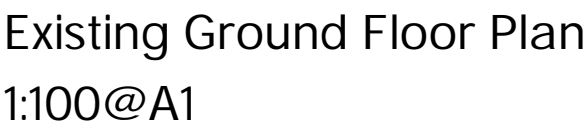
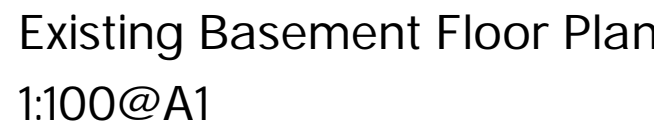

Survey information provided by:
Chris Partington Land Surveyors
44a Green Lane
Sale
Cheshire
M33 5PP
Ref: 230120WW-02

- First Issue

AeJ 01-12-2023

condylofthouse
architects

Client

Almonds Green Developments Ltd.

Project

11-15 Rodney Street, Liverpool. L1 9EF
4-5 Baltimore Street, Liverpool, L1 9BD

Title

Existing Basement and Ground Floor Plans

Scale

1:100@A1 Dec 2023 SURVEY

Drawing No

23-089-20

Revision

x

FOR APPROVAL