

NORTH

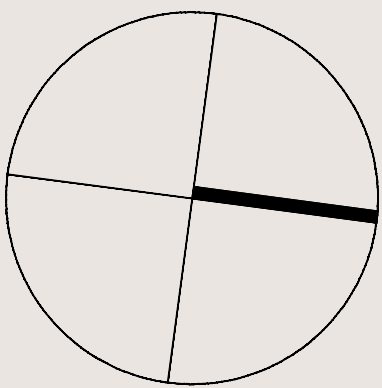

NOTES

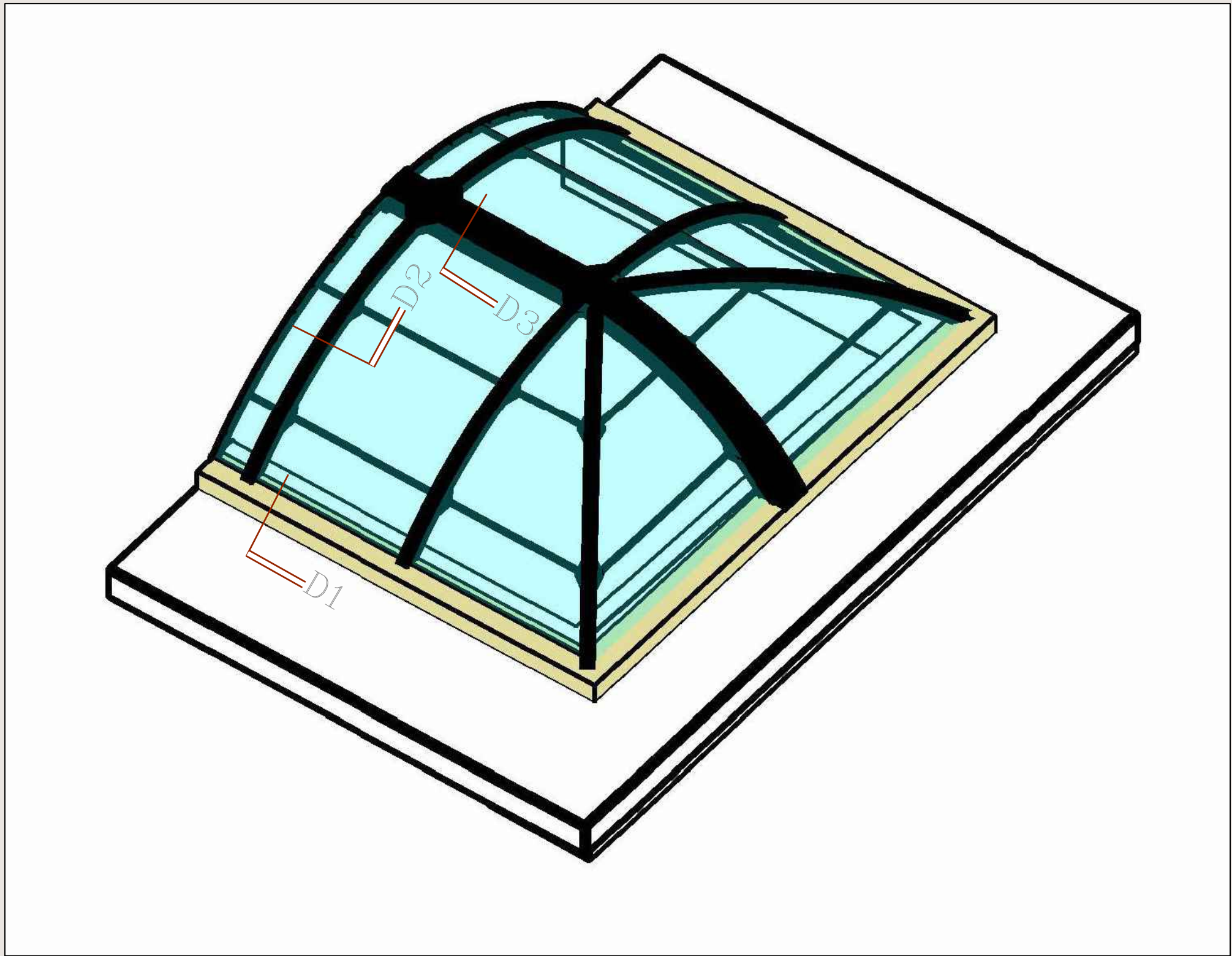

- INSTALLATION
- FASTENERS PROVIDED BY ACURLITE  
(Fastener Size & Type Per Acurlite P.E. Analysis Unless Noted)
  - INSTALL GLAZING PER INDUSTRY STANDARDS  
(Follow GANA Guidelines & Acurlite Installation Manual)
  - USE SPECIFIED DOW CORNING SILICONE  
(Per Acurlite P.E. Analysis & Installation Manual)
  - SNAP ON COVER CAP  
(Not Required For Water Tightness)
  - FASTEN PRESSURE CAP TO RAFTER & APPLY SEAL
  - FASTEN PURLIN ASSEMBLY TO RAFTER
  - APPLY CONT. STRUCTURAL SEAL - IF REQUIRED
  - BACKER ROD & CONTINUOUS SEAL
- ALUM. GLASS REST & SILICONE SETTING BLOCK  
(Located At Quarter Points - 2 Per Bay)
- STRUCTURAL SEAL FLANGE - IF REQUIRED  
(Factory Applied To Purlin - 1/4-20 x 3/4" Flat Head Screw)
- SILICONE GASKET
- EXTRUDED ALUM. COVER CAP & PRESSURE CAP W/ GASKET
- OPTIONS FOR VISUAL ENHANCEMENT
- STANDARD & CUSTOM FINISHES  
(Paint, Anodize & Powder Coat Available)
  - SHADES/LOUVERS - PANELS - BIPV/DYNAMIC GLAZING  
(Consult Factory For Your Project Specific Requirements)
  - VARIABLE RADIUS  
(Consult Factory - Based On Project Specific Conditions)
  - INSULATED LAMINATED / LAMINATED GLAZING  
INCLUDES ALL BACKER ROD & GLAZING SEALANTS  
(Max Unit Size & Required Thickness - Per AAMA Guidelines)  
(Glazing Calculations Provided For Additional Cost)
- EXTRUDED ALUMINUM PURLIN  
(2 1/2" Width - Depth/Reinforcement Per Acurlite P.E. Analysis)
- EXTRUDED ALUMINUM RAFTER  
(2 1/2" Width - Depth/Reinforcement Per Acurlite P.E. Analysis)

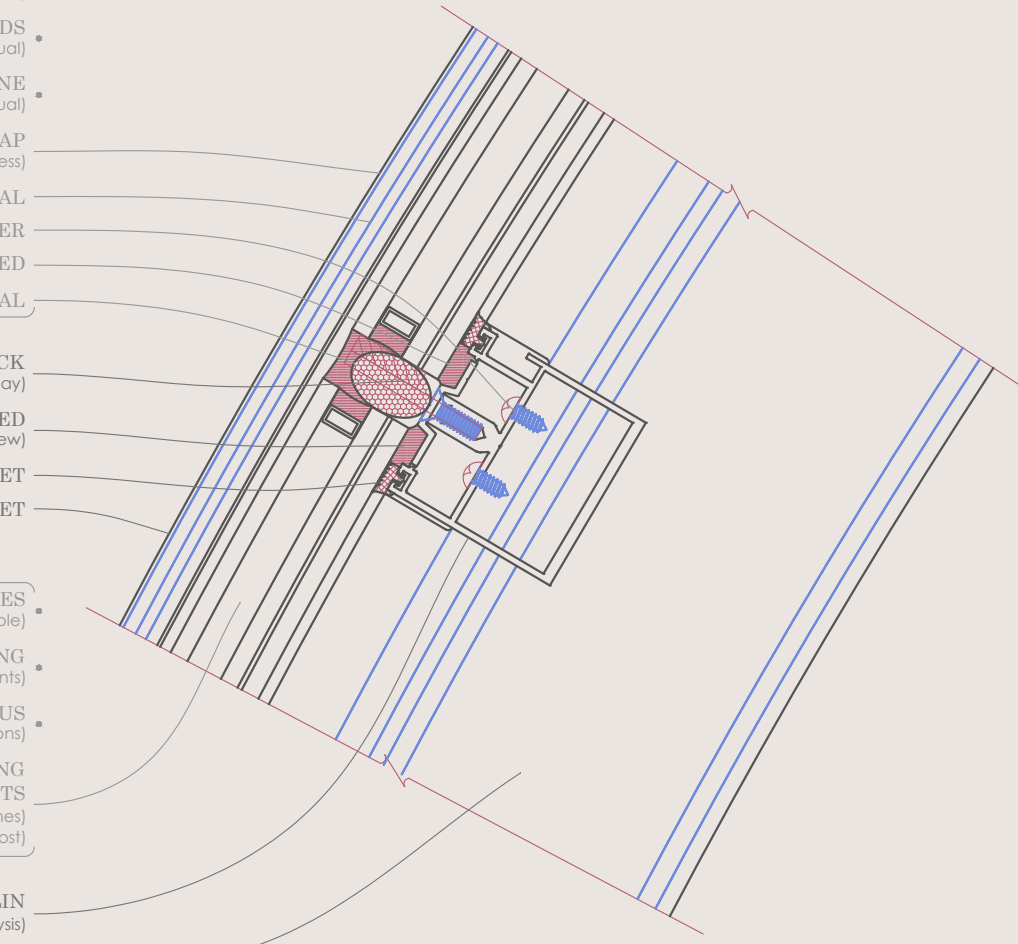

D2 PURLIN  
TYPICAL DETAIL

- OPTIONS FOR VISUAL ENHANCEMENT
- STANDARD & CUSTOM FINISHES  
(Paint, Anodize & Powder Coat Available)
  - SHADES/LOUVERS - PANELS - BIPV/DYNAMIC GLAZING  
(Consult Factory For Your Project Specific Requirements)
  - VARIABLE RADIUS  
(Consult Factory - Based On Project Specific Conditions)
  - INSULATED LAMINATED / LAMINATED GLAZING  
INCLUDES ALL BACKER ROD & GLAZING SEALANTS  
(Max Unit Size & Required Thickness - Per AAMA Guidelines)  
(Glazing Calculations Provided For Additional Cost)
- EXTRUDED ALUM. COVER CAP & PRESSURE CAP W/ GASKET  
(2 1/2" Width - Depth/Reinforcement Per Acurlite P.E. Analysis)
- EXTRUDED ALUMINUM RAFTER  
(2 1/2" Width - Depth/Reinforcement Per Acurlite P.E. Analysis)
- EXTRUDED ALUMINUM PURLIN  
(2 1/2" Width - Depth/Reinforcement Per Acurlite P.E. Analysis)
- SILICONE GASKET
- ALUM. GLASS REST & SILICONE SETTING BLOCK  
(Located At Quarter Points - 2 Per Bay)
- STRUCTURAL SEAL FLANGE - IF REQUIRED  
(Factory Applied To Purlin - 1/4-20 x 3/4" Flat Head Screw)
- FORMED EXTERIOR CLOSURE - 1/16" ALUM. STANDARD  
(Consult Factory For Optional Thickness & Materials)  
(Typical Splice Shown As Dashed Line - Locate As Required)
- SILL LUG  
(Lug Size, Type & Locations Per Acurlite P.E. Analysis)
- FORMED SILL PAN - 1/16" ALUM. STANDARD  
(Consult Factory For Optional Thickness & Materials)
- SPONGE GASKET - FACTORY APPLIED TO SILL PAN  
(3/4" Void At System Weep As Required)
- CURB / SUBSTRUCTURE BY OTHERS
- DETAILS / MATERIALS PER CONTRACT DOCUMENTS  
(Not By Acurlite - Provided By Others)
- ISOLATION/WATERPROOF MEMBRANE  
(Not By Acurlite - Provided By Others)
- PROPER SUBSTRATE REQUIRED FOR ATTACHMENT  
(Not By Acurlite - Provided By Others)

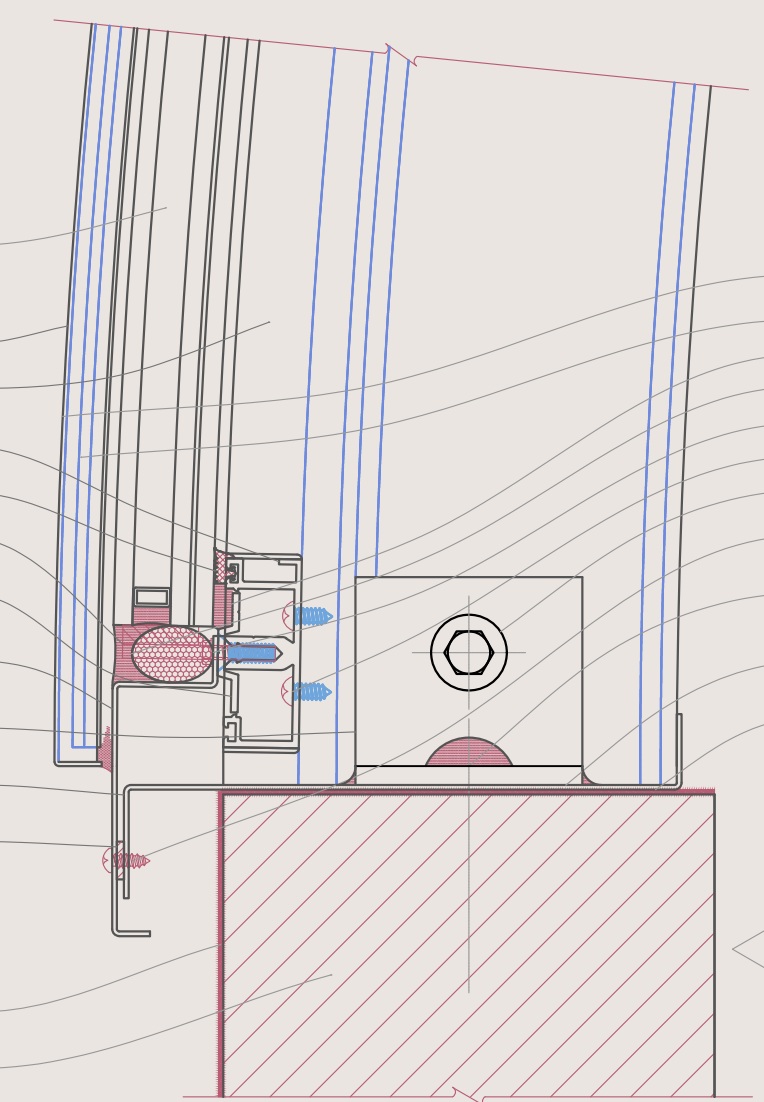

D1 SILL  
TYPICAL DETAIL

- INSTALLATION
- FASTENERS PROVIDED BY ACURLITE  
(Fastener Size & Type Per Acurlite P.E. Analysis Unless Noted)
  - INSTALL GLAZING PER INDUSTRY STANDARDS  
(Follow GANA Guidelines & Acurlite Installation Manual)
  - USE SPECIFIED DOW CORNING SILICONE  
(Per Acurlite P.E. Analysis & Installation Manual)
  - SNAP ON COVER CAP  
(Not Required For Water Tightness)
  - FASTEN PRESSURE CAP TO RAFTER & APPLY SEAL
  - APPLY CONT. STRUCTURAL SEAL - IF REQUIRED
  - BACKER ROD & CONTINUOUS SEAL
  - FASTEN EXTERIOR CLOSURE TO PURLIN / FLANGE
  - FASTEN PURLIN ASSEMBLY TO RAFTER
  - FASTEN RAFTER ASSEMBLY TO LUGS - IF REQ.
  - FASTEN EXTERIOR CLOSURE TO SILL PAN  
(Use #10 x 1/2" Pan Head S.M.S. - Locate 12" O.C. Typical)
  - FASTEN SILL LUG TO CURB  
(Seal In & Around Lug & Fastener)
  - FULL BEARING SHIM - IF REQUIRED  
(1/4" Max. Shim Space Typical - Unless Noted Otherwise)  
(Not By Acurlite - Provided By Others)
  - INSTALL SILL PAN IN BED OF SEALANT
- PLEASE NOTE
- CURB MUST RESIST ALL LOADS/REACTIONS  
IMPOSED BY SKYLIGHT  
(Reactions Provided By Acurlite P.E.)  
(Responsible E.O.R. to Verify and Approve)
- CURB SHOULD BE PLUMB, LEVEL & SQUARE  
PER INDUSTRY STANDARD TOLERANCES  
(Max Allowed +/- 1/8" PER 12" - 0" - Unless Noted Otherwise)  
(Not By Acurlite - Provided By Others)
- ALL ROOFING, TERMINATION BARS, REGLETS,  
COUNTER FLASHINGS & FLASHINGS NOT  
INTEGRAL TO SKYLIGHT SYSTEM FUNCTION  
(Not By Acurlite - Provided By Others)

- INSTALLATION
- FASTENERS PROVIDED BY ACURLITE  
(Fastener Size & Type Per Acurlite P.E. Analysis Unless Noted)
  - INSTALL GLAZING PER INDUSTRY STANDARDS  
(Follow GANA Guidelines & Acurlite Installation Manual)
  - USE SPECIFIED DOW CORNING SILICONE  
(Per Acurlite P.E. Analysis & Installation Manual)
  - SNAP ON COVER CAP  
(Not Required For Water Tightness)
  - FASTEN PRESSURE CAP TO RAFTER & APPLY SEAL
  - BACKER ROD & CONTINUOUS SEAL
  - APPLY CONT. STRUCTURAL SEAL - IF REQUIRED
  - FASTEN PURLIN ASSEMBLY TO RAFTER
  - FASTEN RAFTER ASSEMBLY TO LUGS - IF REQ.
  - FASTEN EXTERIOR CLOSURE TO SILL PAN  
(Use #10 x 1/2" Pan Head S.M.S. - Locate 12" O.C. Typical)
  - FASTEN SILL LUG TO CURB  
(Seal In & Around Lug & Fastener)
  - FULL BEARING SHIM - IF REQUIRED  
(1/4" Max. Shim Space Typical - Unless Noted Otherwise)  
(Not By Acurlite - Provided By Others)
  - INSTALL SILL PAN IN BED OF SEALANT

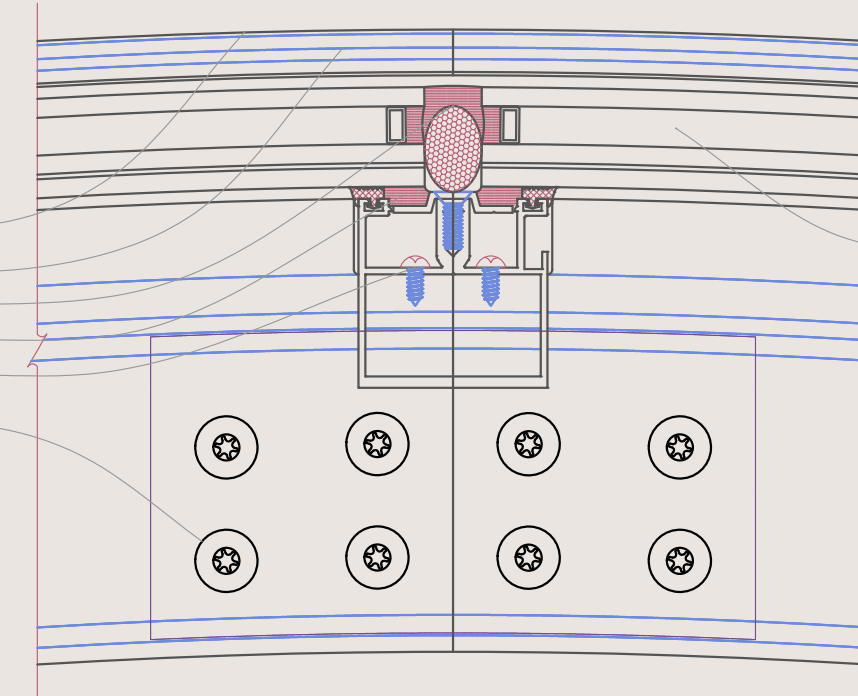

D3 RIDGE  
TYPICAL DETAIL

- OPTIONS FOR VISUAL ENHANCEMENT
- STANDARD & CUSTOM FINISHES  
(Paint, Anodize & Powder Coat Available)
  - SHADES/LOUVERS - PANELS - BIPV/DYNAMIC GLAZING  
(Consult Factory For Your Project Specific Requirements)
  - VARIABLE RADIUS  
(Consult Factory - Based On Project Specific Conditions)
  - INSULATED LAMINATED / LAMINATED GLAZING  
INCLUDES ALL BACKER ROD & GLAZING SEALANTS  
(Max Unit Size & Required Thickness - Per AAMA Guidelines)  
(Glazing Calculations Provided For Additional Cost)

OWNERSHIP NAME:			
PAYMAN HOLDINGS 5 Ltd			
15 Sherbourne Close, Camvridge, CB4,1RT 03334444324 ext. 1041			
PROJECT NAME:			
ROYAL HOTEL KETTERING			
SITE			
Market Place, Kettering, NN16 0AJ			
DRAWING TITLE			
Skylight Drawings			
DRAWING STATUS			
Preliminary			
SCALE			
1:50 @A1			
DATE			
M. T.R. J.J.			
DRAWN			
CHECK			
DWG NO.			
REVISION			